



Cyngor Mynyddda Prydain

Avoiding Rocky Outcomes

***The BMC's experience as a
landowner.***



BMC's Portfolio

- Own 7 Sites
- Lease 1 abandoned quarry
- Formal agreements on a number of others.
- A range of unusual and potentially risky sites
- A number of disused/abandoned former quarrying sites

Horseshoe Quarry, Peak District



Harrison's Rocks, East Sussex

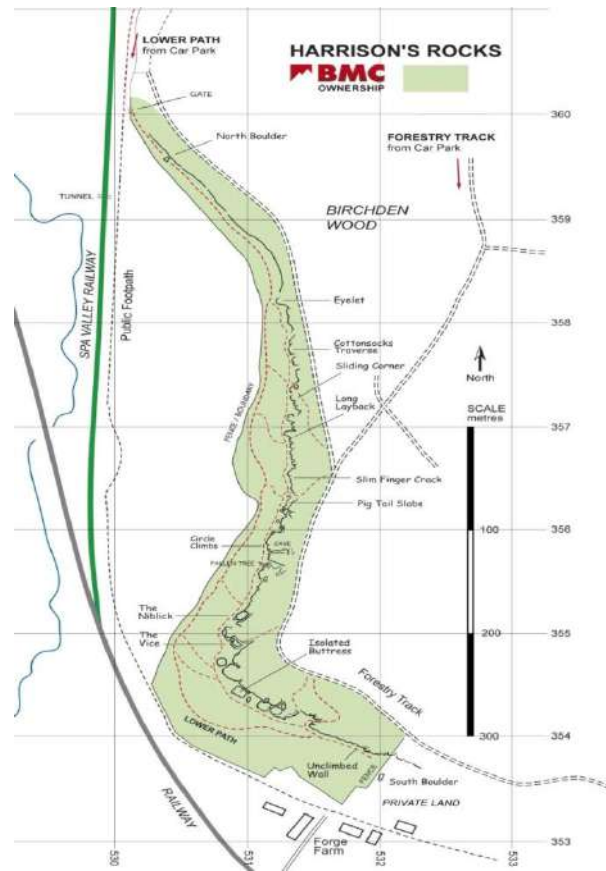

Wilton, Lancs



Craig y Longridge (Greenbank quarry) Lancs



Craig Bwlch y Moch Tremadog



Pen Trwyn – Great Orme's Head

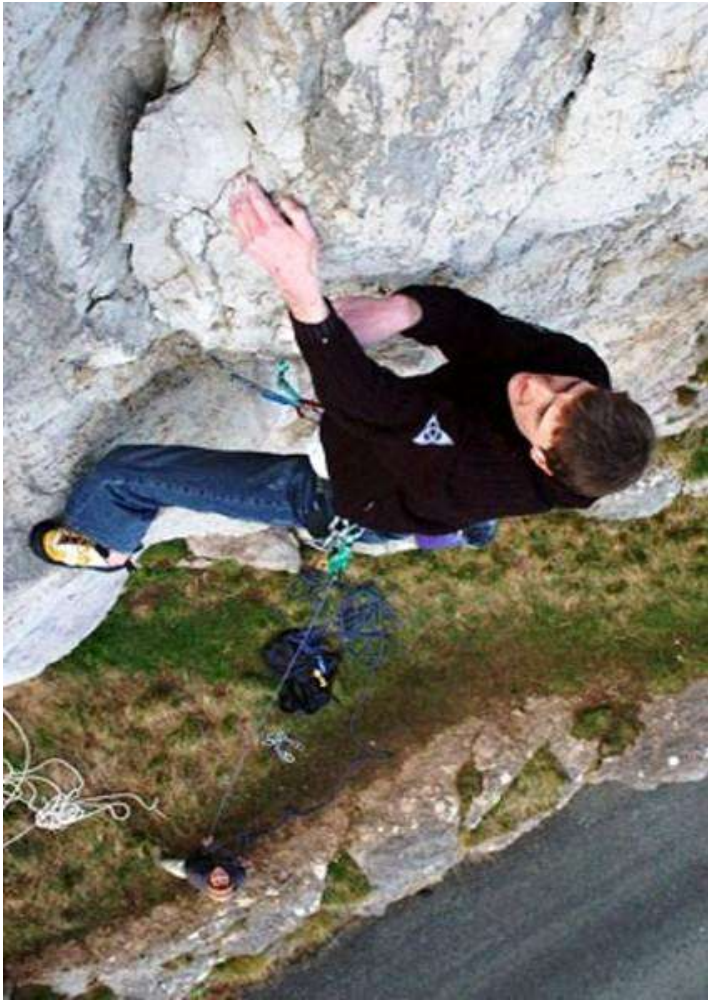

Management policy

- Overseen by Land Management Group
- Day to Day management supervised by officers
- Property Files maintained by officers
- In practice day to day surveillance and minor works delegated to local volunteers
- Local management groups established in many cases

The approach

- BMC's View
 - Climbers willingly accept the risks
 - Participation statement
 - Most hazards are obvious
 - Most hazards are “natural”
- The Issues
 - Rock-fall
 - Tree safety
 - Fixed equipment
 - Dealing with non-climbers

Activities

- Annual documented site inspections
- Issues have mainly been general management – boundaries, signage woodland work
- Some sites have high (legally designated) conservation status
- Accident recording (if known about)

Issues

- Policy to dedicate as open access under CROW Act – reduces liability.
- Fixed equipment monitoring and responsibility
- Conservation Management
- Signage
- Duty of care to non-climbers
- Trees!!

Rock-fall and dangerous trees



Bolts and Beech Trees

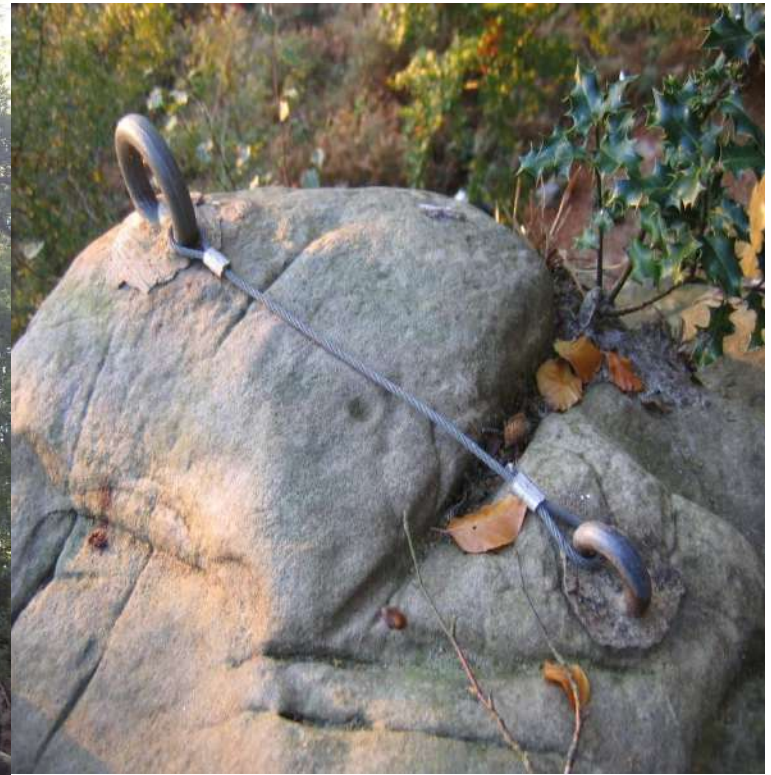

Warnings – useful or should we do more?



BMC Participation Statement

- **The BMC recognises that climbing, hill-walking and mountaineering are activities with a danger of personal injury or death. Participants in these activities should be aware of, and accept, these risks, and be responsible for their own actions and involvement.**